



BLUECREST
HOMES



BONAIRE

BASE PLAN STARTING AT:

4 BED | 3 FULL BATH | 2,682 SQ. FT.

Overall Home Dimensions: 60' Wide x 68' Deep (including porches, & deck stairs)

FIRST FLOOR

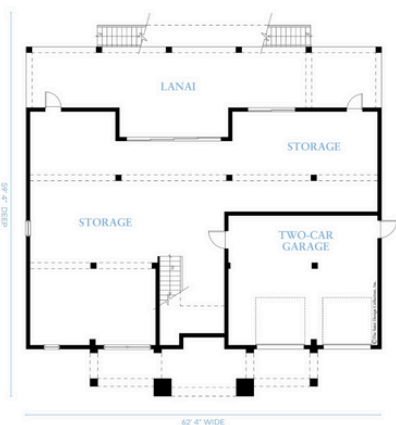

SECOND FLOOR



Plan Features

- 2-Level Home
- 2-Car Garage
- Main Level Study
- Rear Covered Patio
- Main Level Primary Suite
- Open Main Level Layout
- Rear Covered Porch
- Front Covered Porch

PRICE:
\$1,150,727

Price reflects the maximum heated square footage for the plan and includes the cost of any room addition options shown

Learn More
about this plan
here:



CARIBBEAN COLLECTION

Square footage, options, and plan configurations may vary per project and are subject to change. Renderings and floorplans are artist's concepts and are subject to change.